

© This drawing/disk and the works depicted are the copyright of Building Design Group Ltd and may not be reproduced or amended, except by written permission. No liability will be accepted for any amendments made by other persons.
Do not scale figured dimensions only are to be taken from this drawing.

DRAWING STATUS CODE
 PP - Pre-planning application T1 - Tender purposes
 Plan - Planning application made C - Construction
 De - Detail design AB - As built

NOTES
 Drawing to be read in conjunction with all other architects drawings & specifications, consultants and specialists drawings, specifications, construction notes, statutory approvals and employers requirements.

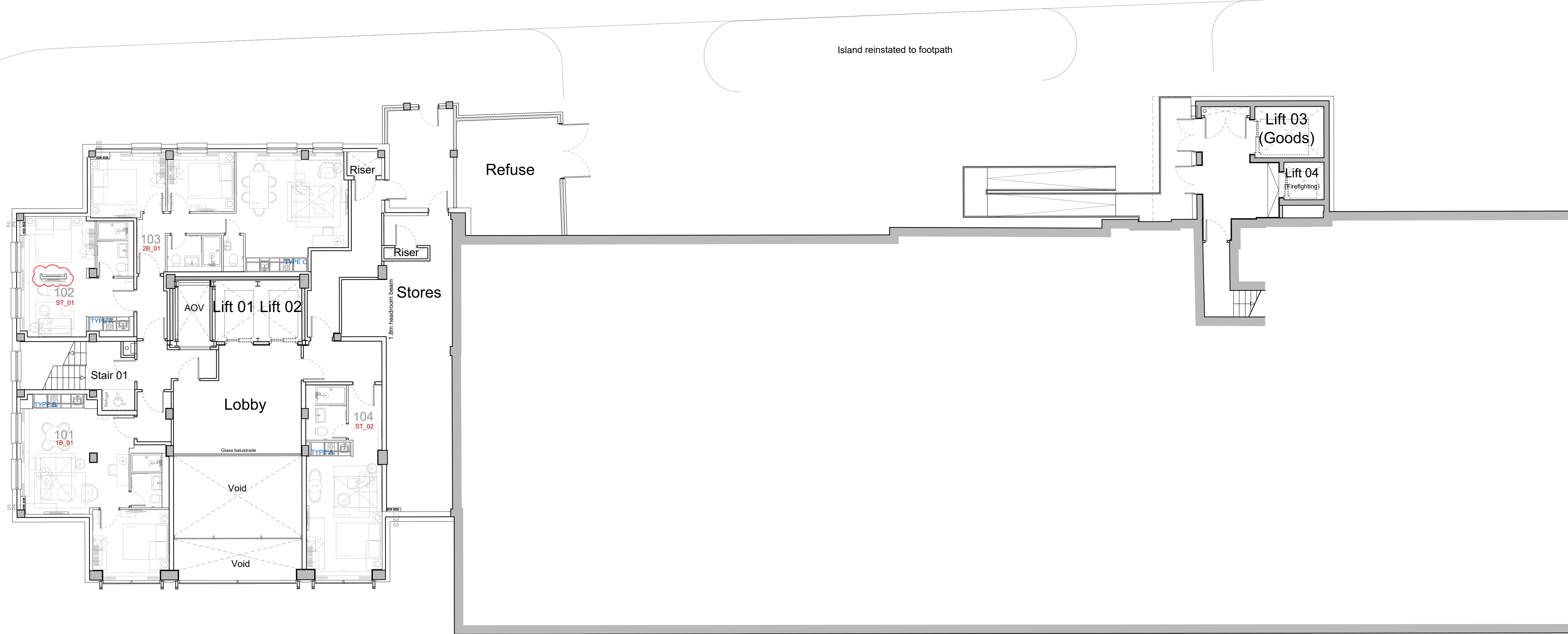
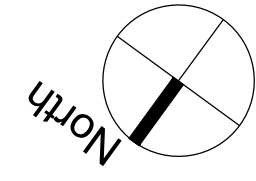

REVISION	DATE	BY
Y	04/01/23	OC
X	05/09/22	OC
W	18/08/22	NC
V	22/06/22	OC
U	05/04/22	OC
T	15/02/22	OC
S	26/01/22	BS
R	25/11/21	JP
Q	25/11/21	JP
P	04/11/21	JP
N	13/10/21	OC
M	10/06/21	OC
L	26/04/21	JP
K	02/02/21	SK
J	09/12/20	OC
H	23/11/20	OC
G	12/11/20	SK
F	12/11/20	SK
E	09/11/20	SK
D	26/10/20	IBH
C	05/10/20	SK
B	29/09/20	IBH
A	11/09/20	IBH

B | D | G Building Design Group Ltd
 Architecture | Urban Design | Master Planning | Interiors
 www.bdg.uk.com
 Tamworth | 1st Floor suite, Biltenscote House, Bonehill Road, Tamworth, B78 3HQ. t: +44 (0)1827 60465
 Birmingham | Grosvenor House, 11 Saint Paul's Square, Birmingham, B3 1RB. t: +44 (0)121 272 3647



CLIENT Seven Capital (GC) Ltd

PROJECT Royal Angus Hotel Birmingham

TITLE Proposed First GA Plan

SCALE @A1 1:100 **DATE** Sept 2020

DRAWN IBH **CHECKED**

DRAWING NO. 3235-201 **STATUS** De **REVISION** Y